

Typical Webserver System Wiring Overview

WEB-MASTER Includes:

- Web Server
- IP Router
- BACnet Router

To main building IT router, if desired to have Price equipment visible over internet, otherwise, a computer can be plugged directly into a LAN port of the Price supplied IP router to view all devices on the Webserver

WEB-ADDITIONAL Includes:

- BACnet Router
- Each BACnet Router can support up to 30 devices

24 VAC Power Wiring:

Connect to dedicated transformer mounted with Webserver equipment. 24 VAC hot/common polarity is critical, 24 VAC common must be earth grounded.

TO 24 VAC Power Transformer

DO NOT RELY ON RTU TRANSFORMER TO POWER WEBSERVER EQUIPMENT.

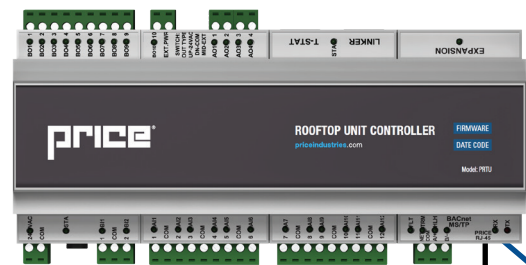

To all zones 1xx

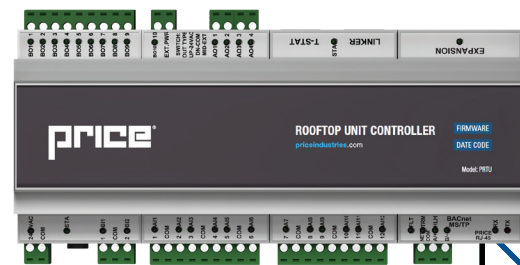

To all zones 2xx

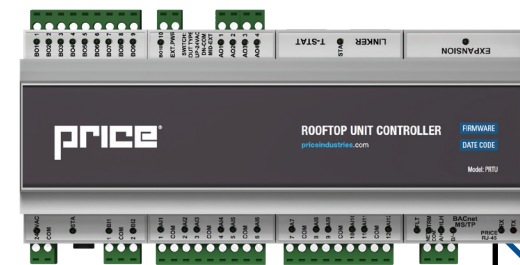

To all zones 3xx

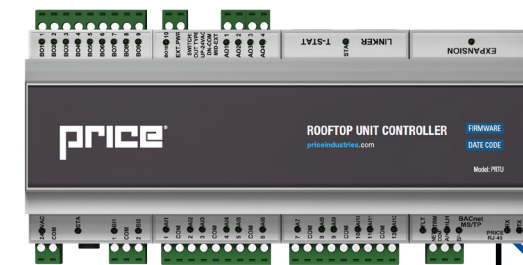

To all zones 4xx

KEY

- Hard wired 24 VAC power (2 wire cable provided by contractor)
- IP connection to CAT 5 to building LAN
- BACnet IP connection (CAT 5 cable provided by Price)
- Hard Wired BACnet MS/TP connection (3 wire cable provided by contractor)
- BACnet MS/TP to zones (CAT 5 cable provided by Price, OR contractor provided 3 wire cable)

Refer to Webserver manual for initial login and detailed setup instructions including graphic creation and setting up static IP for access through building LAN.

Manual can be found at:

<https://www.priceindustries.com/controls/products/price-web-server>

Need to talk to someone? Dial **204 654-5613 option 4**

NOTE: If connecting more than 3 PRTU systems, use an IP switch to free up more ports to plug BAC routers into.

WEB SERVER

INSTALLATION & MOUNTING INSTRUCTIONS

Network Connections

Once the BAC-RTRs have been networked to the PRTU/PIC/Prodigy controllers and the FRONT-END components have been powered up, the IP networks can be connected and tied into the building LAN.

1. Connect the Price Web Server to one of the four "LAN" ports on the IP-RTR using the included 2 foot cable.
2. Connect the BAC-RTRs to the "LAN" ports on the IP-RTR using their included 2 foot cables.
 - a. If required (> 3 BAC-RTRs), the IP-SWITCH is used to expand the "LAN" ports on the IP-RTR
3. Connect the "WAN" port of the IP-RTR to the building LAN system.

NOTE: WAN port is set to DHCP by default

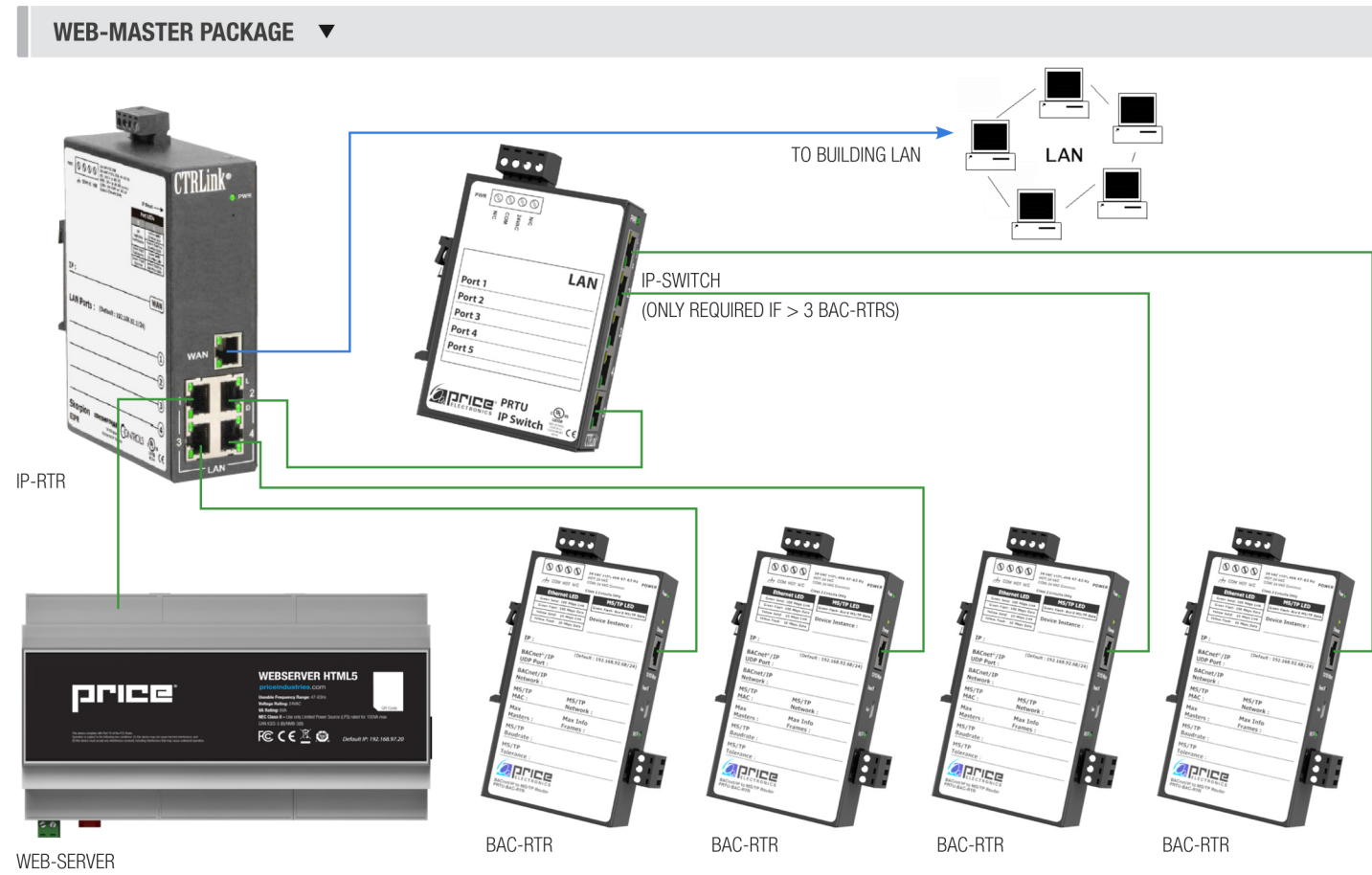

WEB SERVER

SETUP

Web Server Setup

The Price Web Server is pre-loaded with graphics and device templates. To apply these templates, the controllers on the job must be discovered and loaded.

The Web Server is accessed through an internet browser Price recommends using a laptop for the initial setup.

1. Access the Web Server

There are two ways to accomplish this:

- a. From the building LAN: Connect your computer to the building's computer LAN. Open a web browser and go to the address given to you by IT and set up in the previous step. (<http://xxx.xxx.xxx.xxx>)
- b. If your computer is still connected on the LAN side of the IP-RTR, you can access the Web Server directly by going to <http://192.168.97.20>

NOTE: You may NOT use this method if you were forced to disconnect a BAC-RTR to access the IP-RTR in the last step. If this is the case, reconnect the BAC-RTR now and connect your computer to the Web Server using method a. above.)

2. Login to the Web Server:

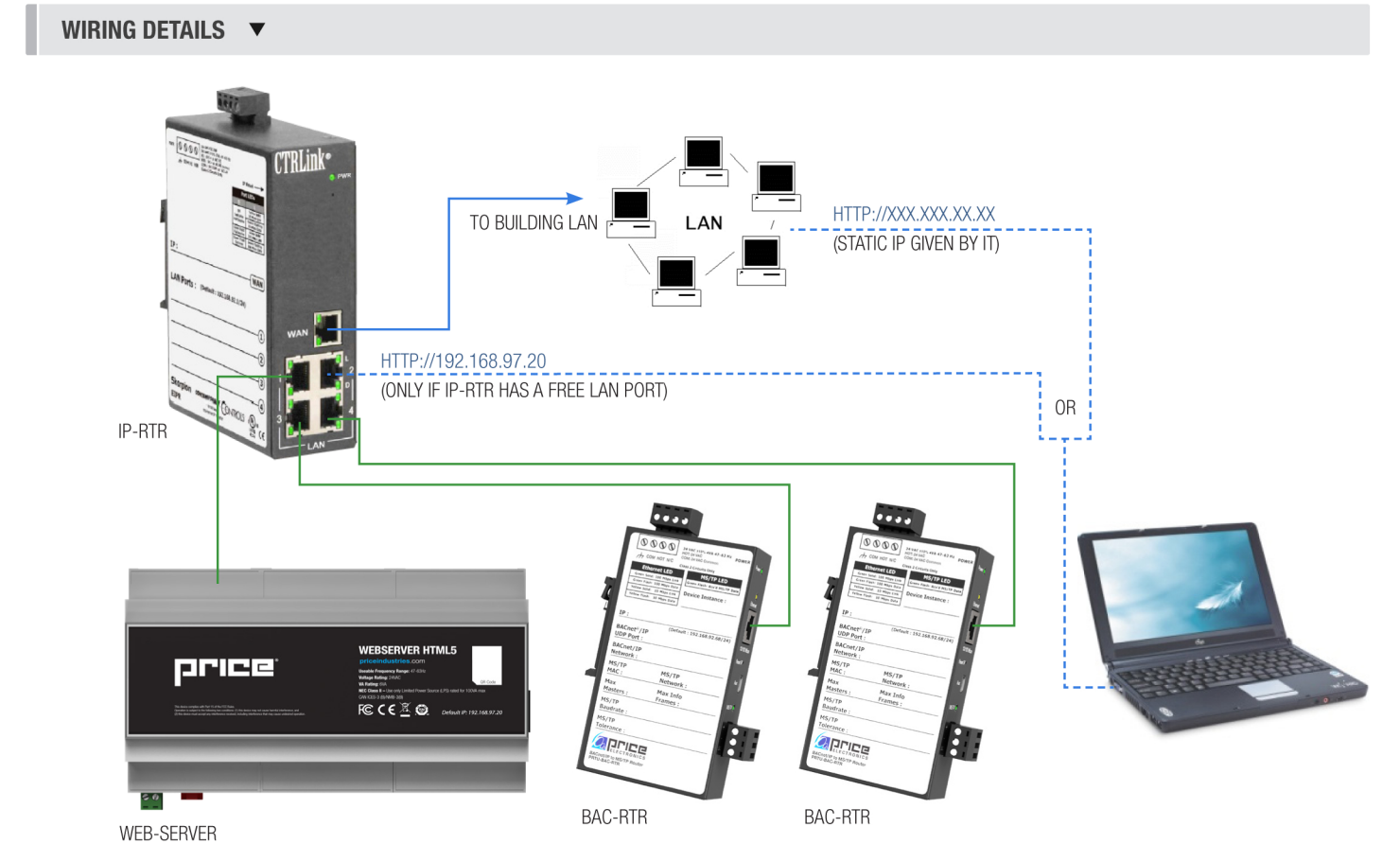

Avoid removing power from the Price Web Server without properly shutting it down by selecting "Shutdown" from the Administrator menu.